

4

3

2

1

DRAWING NO.  
70953

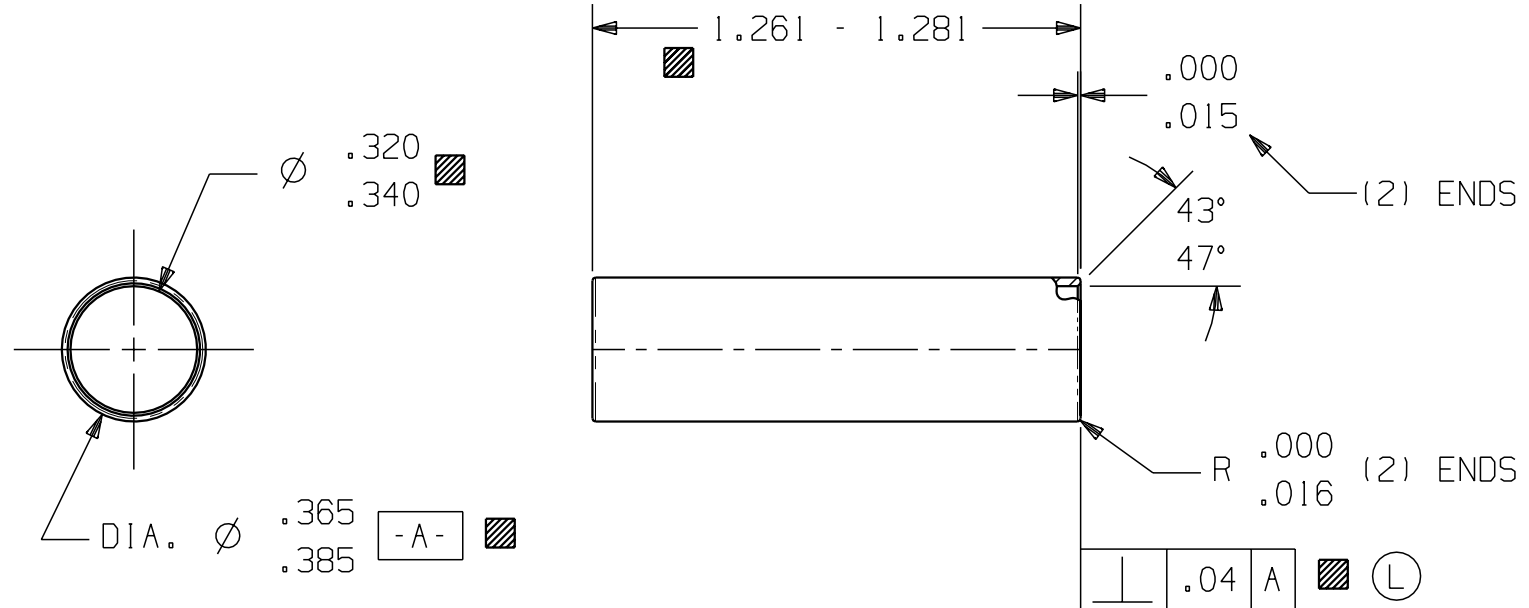

NOTES:

- (M) 1. FINISH - ZINC PLATE .0005 MIN. THICK WITH TRIVALENT CHROMIUM PASSIVATION FREE OF HEXAVALENT CHROMIUM PER T.P. CO. SPEC. #H-43.
- 2. MUST BE CLEAN & FREE OF BURRS & SHARP EDGES.

(G) ALTERNATIVE TO PART #71000

Q.A. SYMBOLS	
	= CATEGORY I
	= CATEGORY II
	= CATEGORY III
	= CATEGORY IV

PROJ. #1939 "RK"

User: rsnyder Part/Rev: rk-70953_m-a-prt Date: 31-Jan-06 Time: 12:09		TS 18JAN06		LUCAS 18MAR05		MCB 17NOV00		PAT		WRIGHT 02JUN00		R. COWEN 1-22-90		A.S.C. 4/4/89		DATE							
M	4B	#244405-000	CHANGED NOTE	L	IB	#243687-000	REDRAWN IN 3D ADDED PERP. TOLERANCE	K	--	APR.	PAT	J	--	H	-	G	B	F	-	LC	CHANGE	DATE	
																						THIS DRAWING OR PRINT (I.I.) IS THE PROPERTY OF TECUMSEH PRODUCTS. PROPRIETARY AND CONFIDENTIAL INFORMATION BELONGING TO TECUMSEH. (I.I.) IS MADE AVAILABLE TO THE RECIPIENT ON THE EXPRESS AND SPECIFIC CONDITION THAT NEITHER IT NOR THE INFORMATION CONTAINED THEREON OR DISCLOSED THEREIN SHALL BE DISCLOSED OR MADE AVAILABLE TO OTHERS WITHOUT THE EXPRESS AND SPECIFIC WRITTEN CONSENT OF TECUMSEH AND THAT SUCH INFORMATION ONLY AS EXPRESSLY AND SPECIFICALLY APPROVED IN WRITING BY TECUMSEH AND NOT OTHERWISE. (I.I.) SHALL NOT BE COPIED OR DUPLICATED IN ANY MANNER OR TO ANY EXTENT WITHOUT TECUMSEH'S PRIOR EXPRESS AND SPECIFIC WRITTEN CONSENT. (I.I.) SHALL BE RETURNED TO TECUMSEH AT THE RECIPIENT'S REQUEST PROMPTLY AFTER SUCH REQUEST IS MADE.	
																						DIS. CODE	
																						NAME	
																						MOUNTING SLEEVE	
																						DWN. S. CRAIG 6/6/85	
																						CK. McCAUGHEY 1-22-90	
																						APR. BLANDEN	
																						SCALE 2"=1"	
																						THIS PRINT SUPERSEDES ALL PRINTS PRIOR TO	
																						DRAWING NO.	
																						70953	
																						MATERIAL	
																						LOW CARBON STEEL PER SAE J526	

4

3

2

1

C

C

B

B

A

A